



Creative
environments



Basildon Hospital - Mental Health Refurbishment

Value: £2m

Location: Basildon

Services:

Building Services (MEP)

“ ONE’s Engineering team provided a fully compliant HTM solution which was appropriate and safe for a mental health facility. ”

Marcus Spencer
Technical Director, ONE

The Brief

Through the P22 Framework, ONE's mechanical and electrical engineers were commissioned for a building services solution for the refurbishment of two mental health wards of Basildon Hospital.

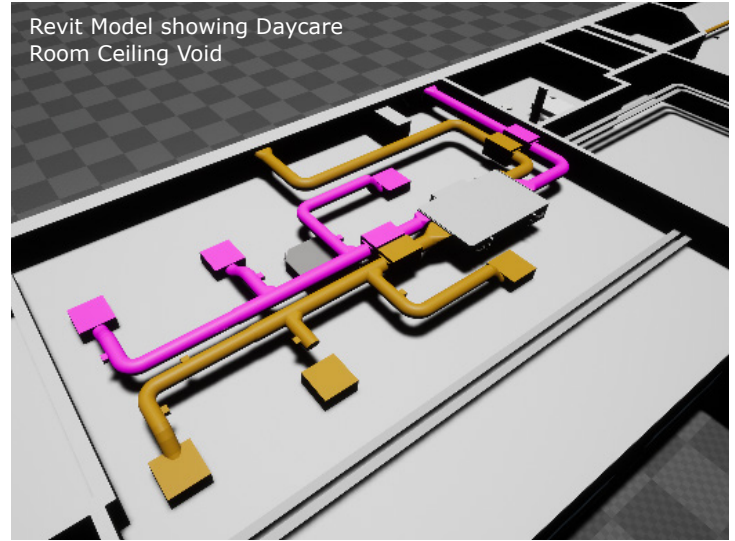

Project Overview

ONE's Mechanical and Electrical engineers provided a HTM fully compliant solution for the two mental health wards of Basildon Hospital up to RIBA Stage 4.

The project required the conversion of a number of communal rooms into 16 individual ensuite rooms on each ward. The team needed to understand the existing infrastructure, as well as the requirements for the new, and ensure that the work was not be disruptive as it needed to be undertaken in a live hospital environment.

The client could be confident that the team had fully considered all safety aspects required by the mental health sector, for example, security and observation points, touchless taps, anti-ligature solutions and movement sensors for beds.

The detailed design for tender was completed by the team and the project is now complete.



Revit Model showing Bedroom View

The Benefits

Experience of working in a live environment – The team understands the complexities of safely delivering a project in a live site while ensuring there is no disruption to services as the work is undertaken

Understanding the requirements of mental health projects – The company works across sectors and has completed more than £600m of healthcare projects in the last decade. The client could be confident that the team would provide an appropriate solution that had fully considered the requirements for mental health facilities.